

MULTI-PURPOSE LOGISTIC SUPPORT SHELTER

MIL – EMS 20



TECHNICAL DATA

- Overall outdoor dimensions : 6058x2438x2591(H)mm
- Weight : 2000 Kg
- Actual load on crane handle : 650 Kg
- Actual load on four points bearing : 1300 Kg
- Actual load on four points bearing : 2000 Kg

CONSTRUCTION

- Steel strength structure, suitable for road transport
- Thermal insulation of mineral wool
- Heat transfer 0.7 W/m²°C
- Painted RAL 6014

MODULAR CONSTRUCTION

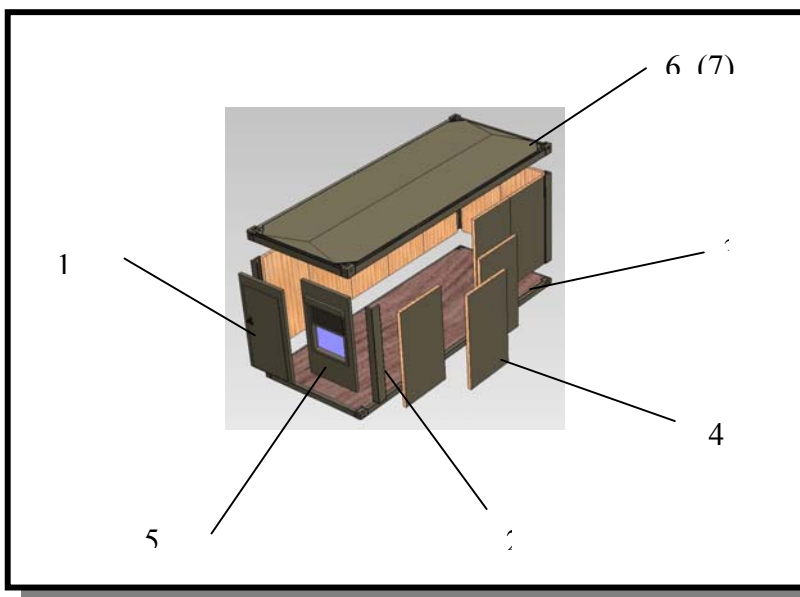

- 1 door outside wall module (1)
- 4 pillar module (2)
- 1 base module (3)
- 12 outside wall module (4)
- 1 window outside wall module (5)
- 1 roof module (6)
- electrical energy module (7)

TRANSPORT

- producer assembled
- kit (embedded) to be assembled in location



OPTIONAL EQUIPMENTS

- Air conditioning unit
- Supplementary electrical and lighting system
- Other systems useful for logistic support applications

APPLICATIONS

- Headquarters units
- Accommodation units
- Warehouse units
- Kitchen units
- Sanitary field units

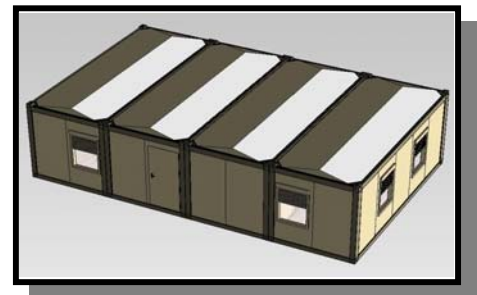

MIL-EMS 20 shelters can be fixed together for complex applications.

